



QUICKPANEL

WALL PANEL SYSTEM

PERMANENT INSULATION

QuickPanels superior insulation with R-values from 2.5 to 9.0 will reduce energy cost in both hot and cold climates. Quickwall Panels can withstand fluctuating temperatures from minus 30 to + 30 degrees. Huge air-conditioned apparel factories constructed from QuickPanel are claiming a 35% reduction in energy costs.

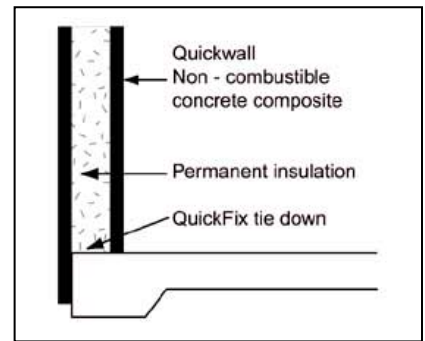

ENGINEERING

Engineers specifying QuickPanel can reduce the mass in foundations, reduce pier and beam dimensions due to the reduction in dead weight load. Raft concrete slabs will generally not require piers resulting in extensive savings. With bricks or concrete weighing in at 2,400 kg per m³ it does not take a mathematical genius to calculate QuickPanel at 252 kg per m³ should seriously be considered in the "Design stage"

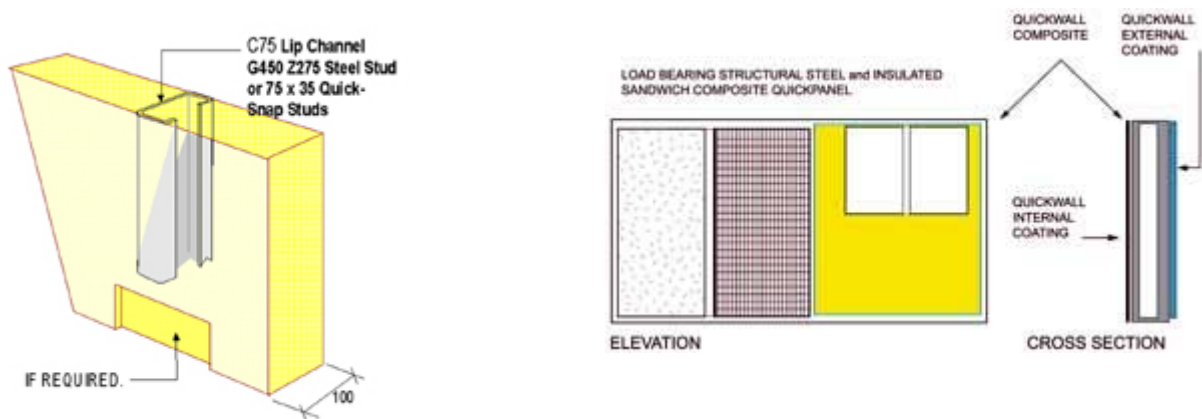

COMPOSITE MATERIALS

The unique composite sandwich material bonded to the metal framing system and insulation forms a monolithic seamless fibre reinforced skin complete with high impact resistance, excellent noise resistant's due hi-density masses and internal fragmented air space, superior modulus of rupture, and excellent biological resistance, no nutriment for termites, energy efficient and environment friendly.

As of the new millennium, the composite sandwich material manufactured under the registered trademark of Quickwall proudly exhibits a failure free history in totally ponding salt-water conditions since 1974. Nothing on the current market today can equal the equivalent track record.

Quickwall does however, reserve the right to change compositions and literature in the presents of consistent improvements.

Important Notice: Test Results and Patent applications to enhance and provide a "system" are formulated on the composites, exclusive polymer technology and finishes manufactured by Quickwall only. Failure to use the specified Quickwall components may render the user liable and the building defective from inferior materials by unqualified or unlicensed manufacturers.

EARLY FIRE HAZARD TEST			
A.S. 1530.3 B.S.476 1987 ANZ.1562.3			
Ignitability	0	Heat Evolved	0
Spread of Flame	0	Smoke Developed	0
Malaysia: Class F		Australia: Class S	
New Zealand: Class S			
Fire retardant QuickPanel insulation board is pre-coated with non-combustible ceramic cement and fibreglass surface treatment in accordance to the quickPanel specifications:			
Quickwall Panels tested by NATA approved Testing Station in accordance to ISO standards for the following structural performances:- Axial / Bending / Compression / Racking.			

SLAB DETAILS

See diagram: ~ Type 1: Typically 90mm thick. Non-structural walls typically 70mm to 90mm thick. Structural wall thickness from 90mm to 220mm

R - VALUE CHART	
Building Systems Thermal Comparisons	R - Value
QUICKPANEL TYPE 1:	2.8
QUICKPANEL TYPE 2:	2.8
QUICKPANEL TYPE 3:	2.5
QUICKPANEL TYPE 4:	9.0
BRICKS	NIL
CEMENT SHEET	NIL
WEATHERBOARD	NIL
MASONRY BLOCK	0.026